

WATERPROOFING SYSTEMS



WATERPROOFING IS ESSENTIAL

Who we are

Waterproofing is an essential part of every building, providing shelter to those beneath it and protecting them from the damaging effects of the elements. As a leading global waterproofing system designer and manufacturer, we are responsible for ensuring our systems perform to the highest standards, safeguarding the building and all that is contained within. We take great pride in this responsibility.

We have a strong industrial heritage, and over 100 years experience manufacturing bituminous membranes. We work hard to ensure we are experts in our field and are committed to only producing the best quality membranes.

Axter Ltd is a subsidiary of Axter SA, and part of the multi-national Colas Group, with ultimate global parent company Bouygues, therefore we have strong industry links and are committed to a proactive sustainable development approach.

What we do

We innovate, design and make high quality, reliable waterproofing systems that are built to last. Through investment in research and development, and ensuring great care is taken throughout the design and manufacturing process, we create robust systems that excel in durability and performance.

Our product offering is continuously updated and we strive to build strong, dynamic partnerships with our Axtershield installer network, customers and clients. We are committed to the delivery of exceptional service, innovative design, and quality manufacturing.

By building successful relationships with our customers, clients and Axtershield installer network, and by following our core values of integrity, collaboration, service and respect, we ensure the right system is only ever supplied in the right application.



OUR SERVICE

Technical

Our experienced Technical Managers play a vital role in the successful design, delivery and installation of our systems. Ideally involved from the very first design stages of a project, our Technical Managers will advise, inspect and prepare all relevant details, and write thorough specifications to meet the requirements of the project.

We work collaboratively with all parties involved to ensure all construction implications and appropriate sequence of works have been considered.

Axter's accountable technical design service works to ensure that all projects are constructed strictly in accordance with all relevant local and international regulations and authorities.

Design

With an experienced design team in house and a professional supplier and design partner network, we offer the full suite of standard designs, as well as project specific bespoke design details. To ensure our systems perform to the highest standards we also provide cut-to-falls insulation design, U-value and condensation risk analysis calculations, rainwater drainage and wind uplift calculations.

We like to be actively involved in the design process from the very beginning of a project, this allows us to ensure the roof design and construction requirements are carefully considered.



[Watch now - Axter Ltd work with Berkeley Homes and Tilbury Contracts at Victory Pier](#)



Quality

We want to maintain our 100% leak free record, and we pride ourselves on our thorough approach to installation and quality assurance (QA). We have rigorous QA procedures for each of our systems which gives in-depth detail on the correct installation procedures and quality checks that should be undertaken throughout the project.

Our highly experienced Quality Division visit each site every fortnight to ensure correct procedures are being followed and consistent quality reports are logged and distributed to all parties involved.

Final site inspections are carried out with our QA managers, the site manager and roofing contractor to ensure all works are completed to the expected standard prior to guarantee sign off.

“Axter will always ensure that the highest industry standards are realised on all projects, and that third party building insurers’ design and construction standards are implemented and achieved without exception”



AXTERSIELD PARTNERSHIP

The Philosophy

Our Axtershield installer (Ai) network is based on promoting a collaborative approach to waterproofing system manufacture and installation. We want to drive up industry standards, eliminate defect and achieve high quality workmanship without compromise. To do this, we must work hand in hand with a qualified and professional network of roofing contractors, that are fully committed to the delivery of Axter waterproofing systems, without fault or need for future remediation.

Becoming an Axtershield Installer

All Axtershield installers undertake specialist product training and all operatives carry system identification cards ascertaining competency level in the specified Axter system. To become a member of the Axtershield network the roofing contractor must demonstrate and prove financial stability, professional competence and sign up to the Axtershield Charter including Axter's Deed of Appointment.



Deed of Appointment

All Axtershield installers sign and adhere to the principles of the Deed of Appointment, which formally clarifies the duties and responsibilities of Axter and the Axtershield installer. The Deed of Appointment ensures that our clients can be reassured that if poor workmanship occurs, the Axtershield installer is duty and legally bound to return and remedy the fault to Axter's satisfaction.

Site quality audits

To give further confidence to clients and in accordance with Axter's Quality Assurance procedures, our Quality Division makes scheduled and unannounced visits to sites to assess the quality of the installation and to raise any discrepancies between the original Axter specification and the site as built. The frequency of such visits depends on the size of the contract and type of guarantee specified.

Guarantee

We provide comprehensive insurance backed guarantees for periods of up to 35 years covering materials, design and workmanship. Additional independent third party insolvency insurance covering the Axtershield installer's workmanship is also provided as part of Axter's Platinum guarantee. This offers further reassurance to our clients that their risk in relation to waterproofing failure is totally indemnified when working with Axter and our Axtershield installer (Ai) network.

Maintenance

We are committed to ensuring that our roofs out perform the guarantee term and we will always be on hand to assist our clients. Regular (bi-annual) inspection of the completed roofing is imperative to ensure that rainwater outlets and gutters are clear of debris and that any observed defect is rectified by the Axtershield installer under the terms of the guarantee.



[Watch now - Waterproofing Made Simple: EXCEL® JOINT Horizontal Expansion Joint](#)

"The partnerships we have with our Axtershield installers are critical to the successful delivery of waterproofing projects.

We take great pride in ensuring our Axtershield installers are the best in the business, fully trained and continuously supported by the Axter team to meet client demands."

Phillip Wilcox-Moore,
Managing Director, Axter Ltd

DESIGN SPECIFY GUARANTEE

Six steps to the perfect waterproofing

We have devised a comprehensive six step guide to ensure every project is analysed, specified, installed and guaranteed to the correct level, and to assure that the right system is selected in the right application. This guide sits alongside the RIBA plan of work, which enables easy identification of the stages required to achieving a perfect roof.

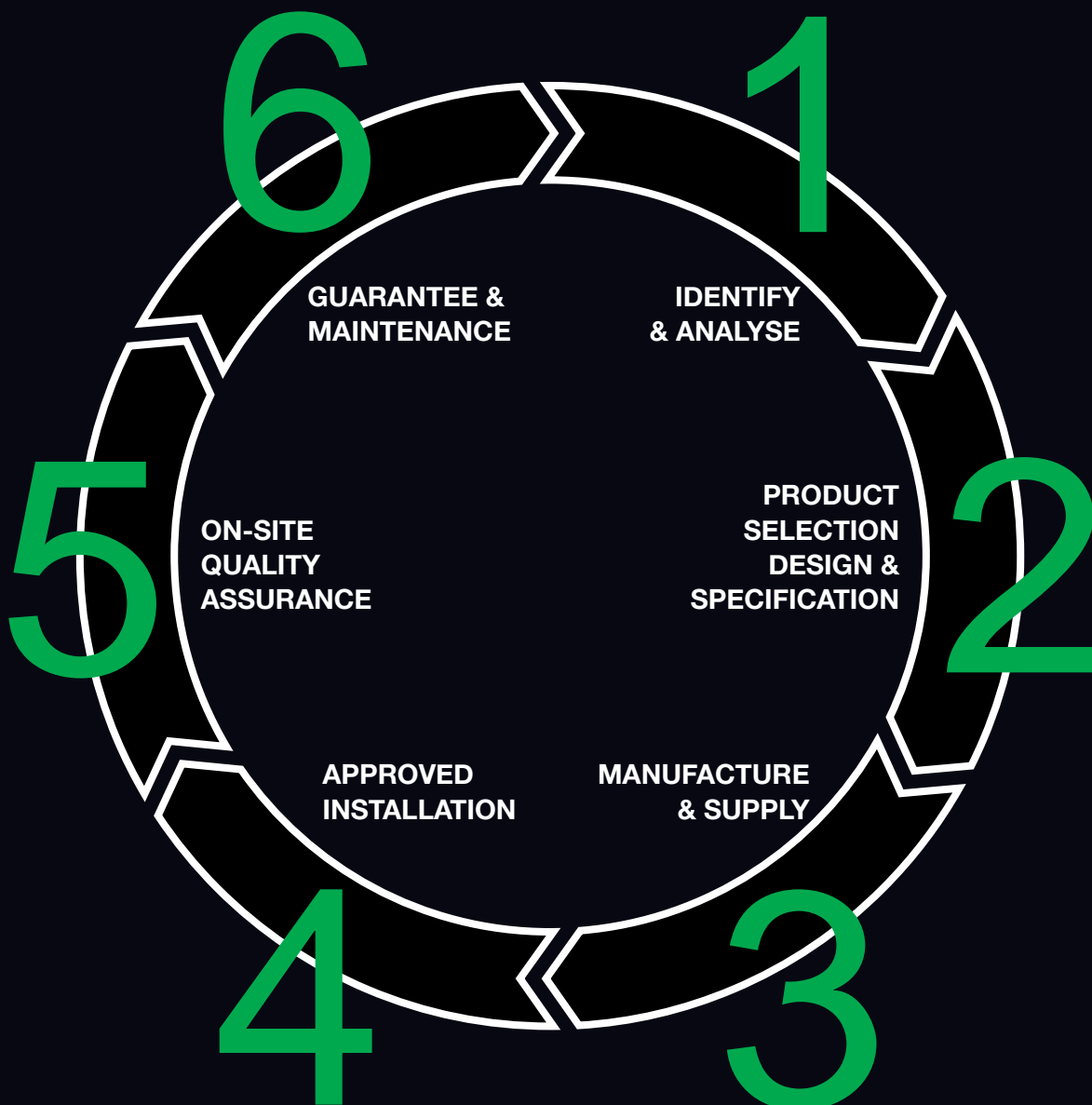

1. IDENTIFY & ANALYSE

- Analysis of key building factors
- Cost, performance, aesthetics, sustainability, design limitations and guarantee
- Basic outline specification

2. PRODUCT SELECTION, DESIGN & SPECIFICATION

- Choosing the right product for the right application
- Axter total product package
- Full specification suite from Axter
- Comprehensive roofing details (project specific and bespoke design as required)
- Compliance with British Standards, Building Regulations, NHBC/LABC (all 3rd party warranty providers) and industry good practice requirements

3. MANUFACTURE & SUPPLY

- ISO9001/ ISO14001 Factory Certification
- Third party certification - BBA, ETA and BRE approvals
- Products ordered and delivered from stock direct to site in factory controlled condition and on time

4. APPROVED INSTALLATION

- Qualified multi-disciplined contractors
- Specialist product training
- Signed deed of appointment

5. ON-SITE QUALITY ASSURANCE

- Knowledge transfer
- Pre-start meetings
- Collaborative quality assurance

6. GUARANTEE & MAINTENANCE

- Guarantee completion
- O&M information pack
- NHBC/LABC (all 3rd party warranty provider) sign off





COMPREHENSIVE GUARANTEES

Workmanship, materials, design

We pride ourselves on our ability to mitigate defects and guarantee a safe, secure and sustainable roof. We do this through project specific design, considered specification implementation and continuous on site quality assurance processes. We can also boast ISO 9001 and 14001 manufacturing procedures and advanced R&D facilities that offer advanced product technology developments.

We have been supplying long-term, insurance backed guarantees for over 30 years, and in that time not one instance of product failure

leading to water ingress has been recorded. A record we are very proud of and intend to maintain!

We offer three levels of guarantee and a range of guarantee periods depending on the system specification. Platinum is our most comprehensive guarantee which can be issued for up to 35 years and provides insurance backed protection for workmanship, materials, design and installer insolvency.

Only members of the Axtershield installer network can achieve a Platinum guarantee level, and they are duty and legally bound to remedy any fault caused by poor workmanship.

PLATINUM

Workmanship
Design
Materials
Installer Solvency Insurance



GOLDSHIELD

Workmanship
Design
Materials



SILVERSHIELD

Workmanship
Materials



BRONZESHIELD

Materials







ROBUST RELIABLE ROOFING

We manufacture flat roof waterproofing systems that provide long term, high performance solutions to suit every application. Our system portfolio is vast, with over 750 different products all engineered to provide unparalleled performance and design flexibility. We offer complete waterproofing systems including all necessary accessories, fixings and insulation. Through our global network of dedicated representatives and over 100 years of manufacturing expertise, our systems are successfully supplied and installed in over 50 countries worldwide.

STRUCTURAL WATERPROOFING

WILOTEKT PLUS

REINFORCED BITUMINOUS MEMBRANES

EXCEL
FORCE DALLE
HYRANGER
CITYFLOR

SINGLE PLY

ECOFLEX

LIQUID WATERPROOFING

STARCOAT QC
STARCOAT PMMA

LIVING ROOF

HYDROSOIL
HYDROBROWN
HYDROSEED
HYDROLITE

SOLAR PV

GENERAL SOLAR PV

WILOTEKT®-PLUS

2nd Generation Structural Hot Melt Waterproofing

Seamless, secure, sustainable

A unique second generation structural hot melt waterproofing system, designed and manufactured for use on all inverted, ballasted, living and blue roof applications. The simplified system build up results in faster installation speeds without compromising on performance, independent roofing contractor testing has proven Wilotekt®-Plus achieves 30% quicker installation speeds over 1st generation systems.



[Watch now - Wilotekt-Plus System Installation](#)



Key Advantages

- Faster and improved application method
- Monolithic system
- Fully adhered with self healing properties
- ETA Approved for zero fall applications
- Highly durable with enhanced damage resistance
- Advanced QA procedure over traditional 1st generation hot melt systems (purple flow grid)
- Simplistic, robust and factory controlled detailing
- Approved for use beneath a variety of hard and soft landscape finishes
- Building lifetime manufacturer service life
- 35 year guarantee to cover workmanship, materials and design

WILOTEKT®-PLUS Inverted Roof Build Up

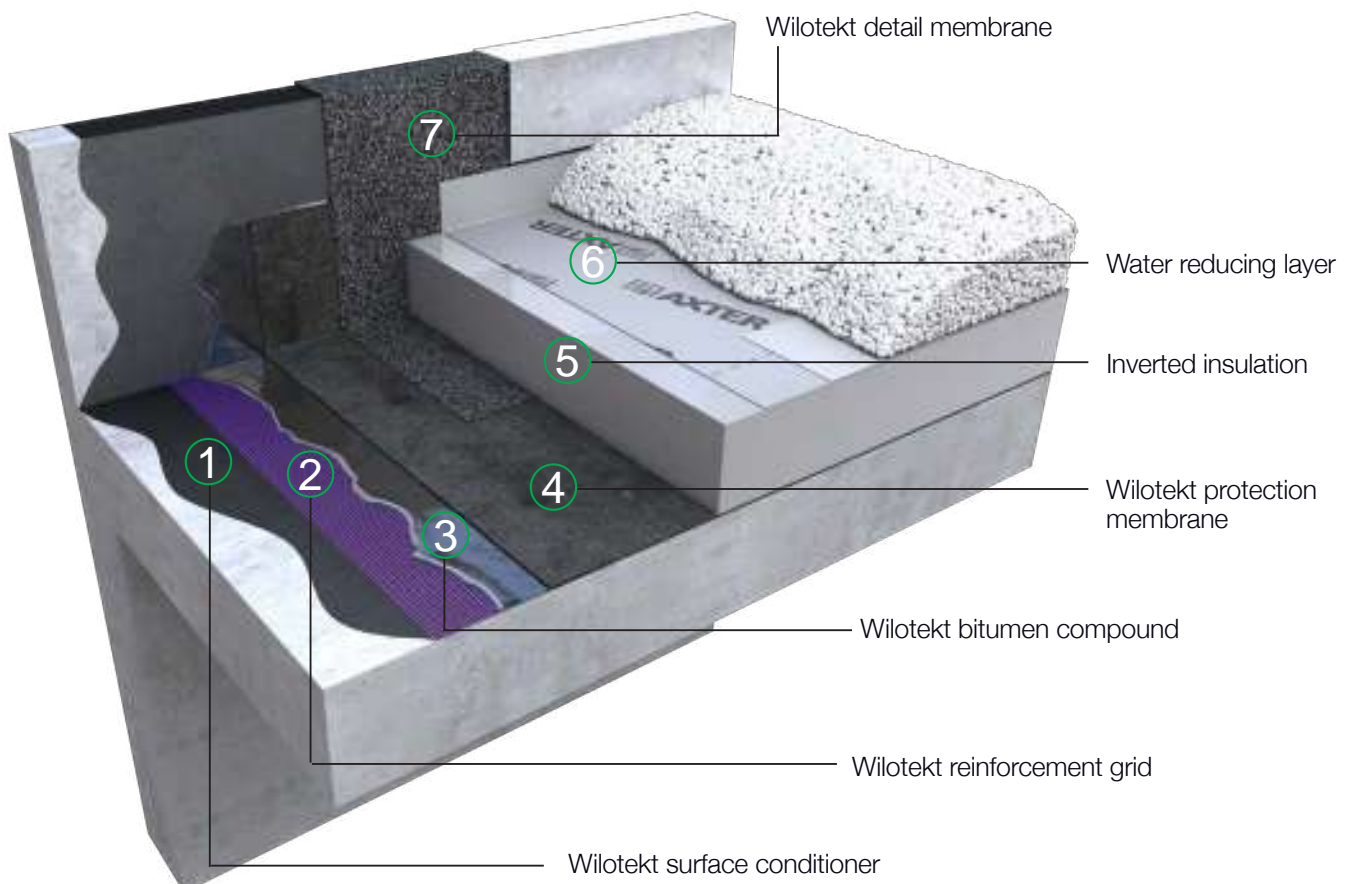



EXCEL[®]

Single or multi-layer ALPA[®] Polymer modified Reinforced Bituminous Membrane

Premium RBM, exceptional longevity

Polyester reinforced ALPA[®] mix polymer modified bituminous membrane, paving the way for new elastomeric membranes. With exceptional performance and ageing characteristics EXCEL[®] has been technologically developed with enhanced durability for use on all new build and refurbished construction projects.



Key Advantages

- ALPA[®] polymer ensures exceptional ageing
- Versatile - approved for warm, cold and inverted
- Approved for use on zero fall structural decks (inverted)
- Approved for all structural deck types (Concrete, Metal, Timber)
- Can be used as a built-up roof or single layer
- Application flexibility - fully adhered, partially bonded or mechanically fastened
- Achieves fire rating EXT.F.AA*
- BBA approved
- 60 year manufacturer service life
- 25 year guarantee covering workmanship, materials and design (60 year design life)

EXCEL[®] Warm Roof Build Up

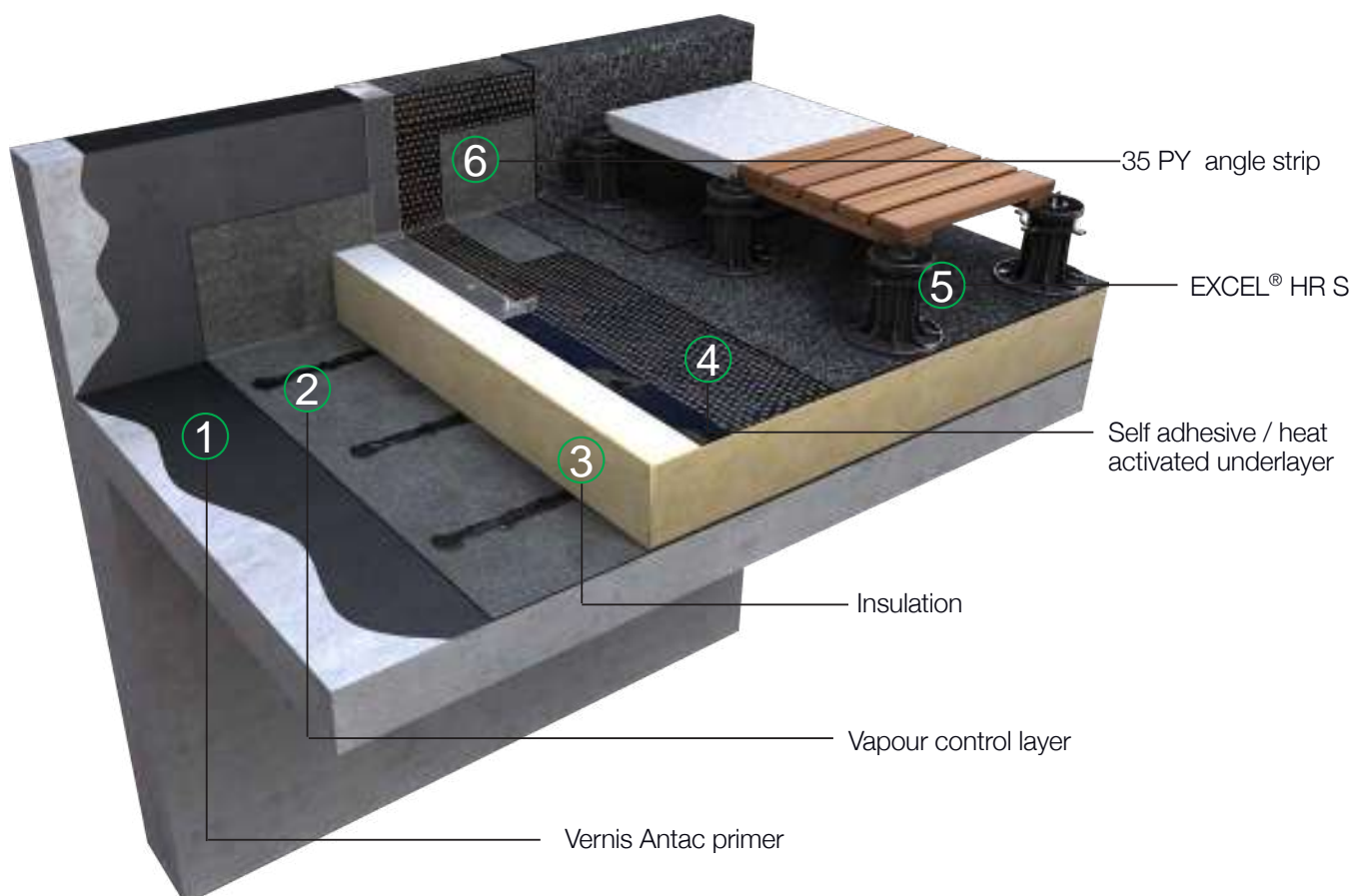

FORCE[®] DALLE

Hybrid structural waterproofing system combining the benefits of hot melt with advanced bituminous membrane technology

Durable, versatile, rapid installation

Multi-purpose bituminous waterproofing membrane with ultra-fast installation process in four easy steps. Robust, reliable and highly durable, FORCE[®] DALLE is designed for use on all roof types in conjunction with all roof finishes, specifically developed to provide added value and speed to the construction process.



[Watch now - Waterproofing Made Simple: Force Dalle](#)



Key Advantages

- Fast installation
- Approved for use on zero degree fall structural decks
- Versatile - can be used on all buried roof types
- Can be used beneath living roof systems
- Cost effective alternative to hot melt systems
- Used as part of a warm or inverted roof design
- Ideal for blue roof design and balcony roof areas
- BBA approved
- 50 year manufacturer service design life
- 20 year guarantee covering workmanship, materials and design

FORCE[®] DALLE Warm Roof Build Up with Blue Roof

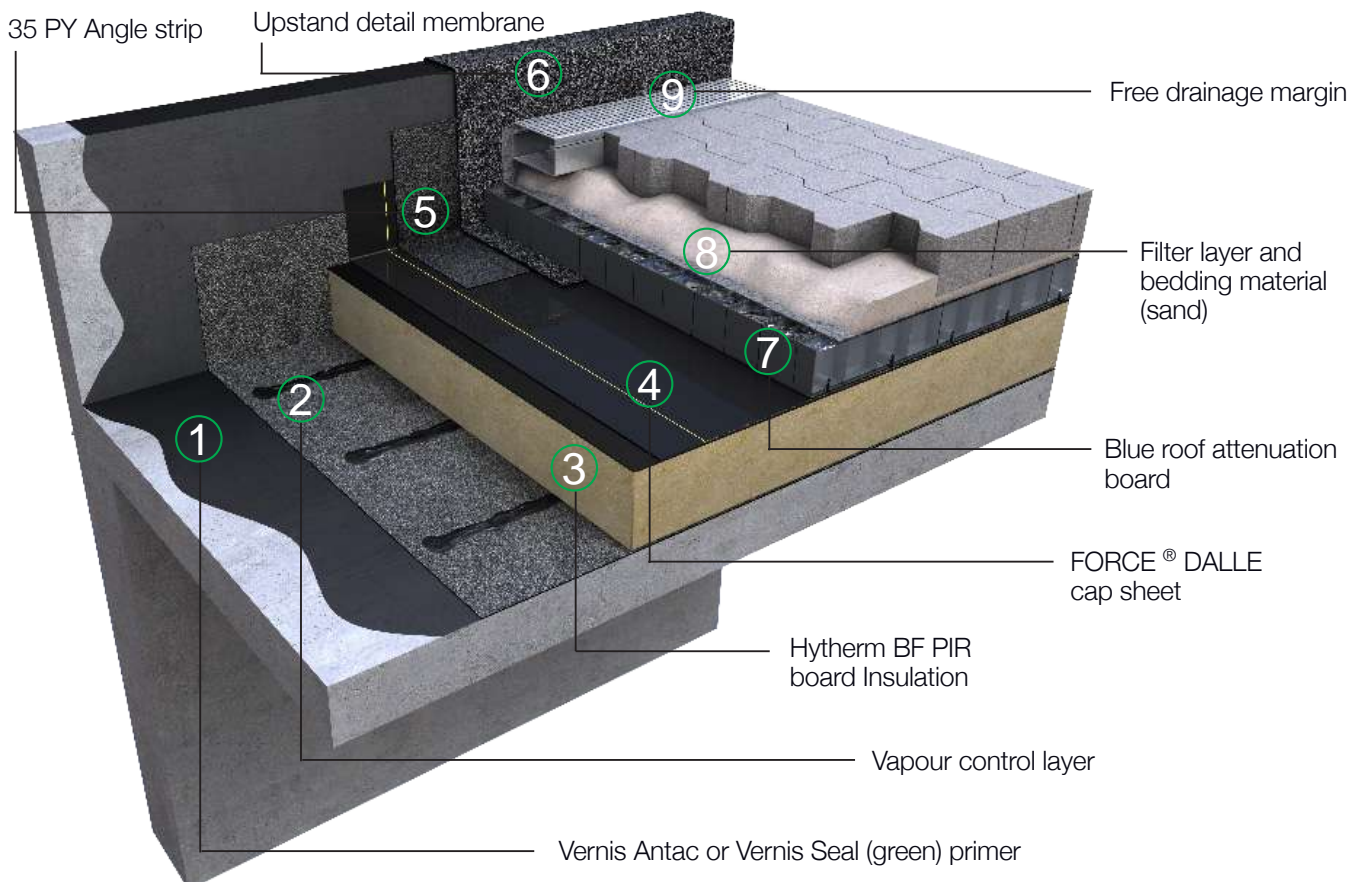

HYRANGER®

Cost effective polymer modified bituminous membrane system

Tried and tested, cost effective RBM

A tried and tested traditional RBM system utilising a polymer modified bituminous membrane, developed to guarantee performance and cost efficiency. Ideal for refurbishment projects due to its tactile, trafficable surface but also suitable for new construction projects, HYRANGER® is suitable for many types of deck and insulation combinations on all types of building.

Key Advantages

- Durable, reliable, cost effective system
- Excellent performance characteristics - elasticity, fatigue resistance, flexibility at low temperatures
- Membrane resists impact and tearing
- Suitable for a variety of applications on both new build and refurbishment, and warm or cold roof
- Can be used under paving or timber decking
- BBA approved
- 50 year manufacturer service life
- 20 year guarantee covering workmanship, materials and design



HYRANGER® Warm Roof Build Up

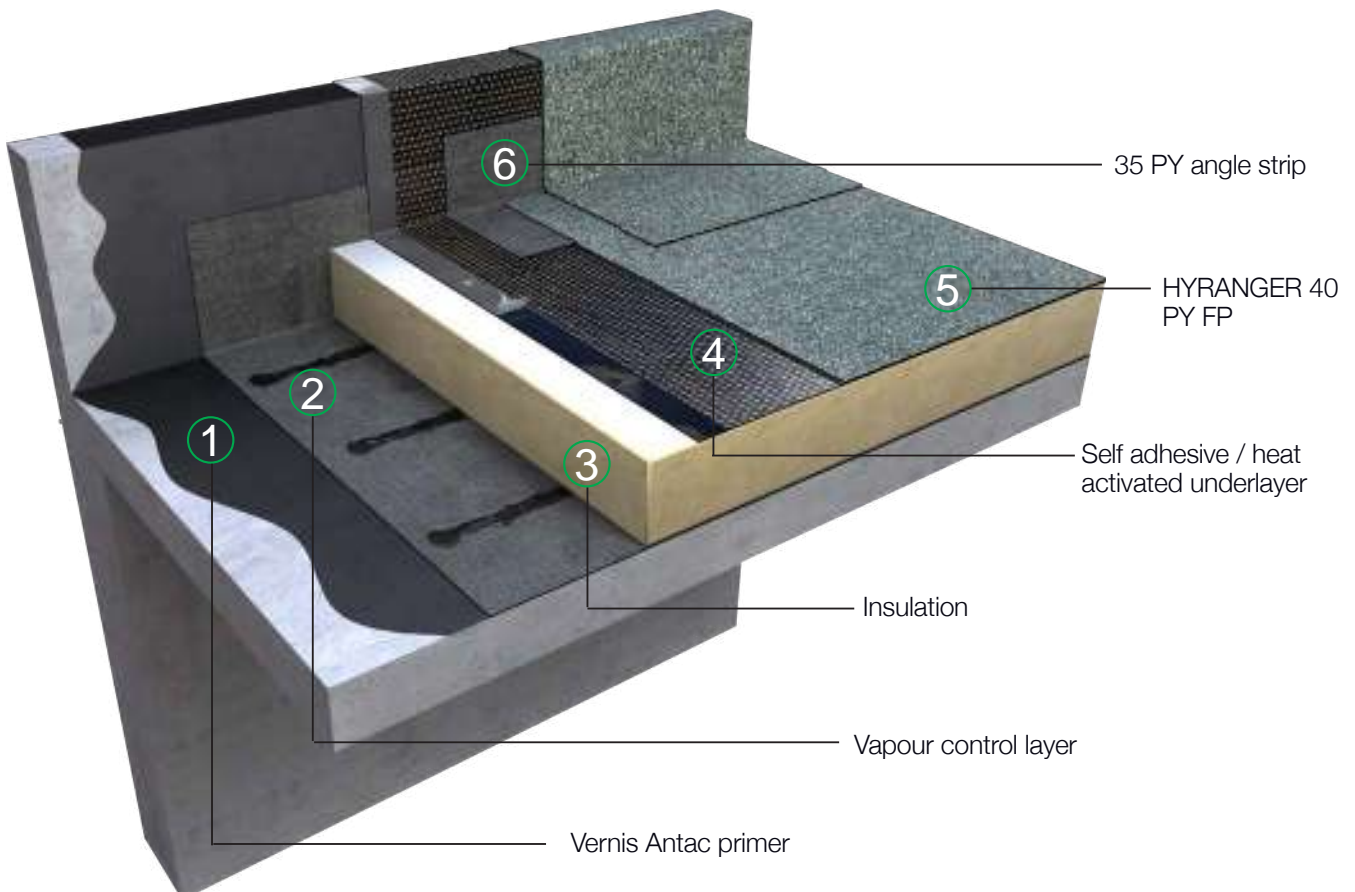

CITYFLOR®

Robust Reinforced Bituminous membrane specifically designed to be used with green roof finishes

Green roof waterproofing solution

SBS modified bitumen membranes for use in intensive and extensive green, brown and bio-diverse roofs as well as protected terrace and balcony applications. With anti-root technology CITYFLOR® has particular resistance to root action, fertilizers and insecticides, and is specifically designed to withstand intensive landscaping finishes and provide single point liability when used with Axter living roof systems.

Key Advantages

- Designed for use beneath living roof systems
- Robust trafficable surface (6.5mm thick)
- Resists root action
- Ideal for new build and roof refurbishment
- Includes torch-on, self-adhesive, mechanically fastened and partial-bond membranes
- Used as part of a warm or inverted roof design
- BBA approved
- 50 year manufacturer service life
- 25 year guarantee covering workmanship, materials and design



CITYFLOR® Warm Roof Build Up

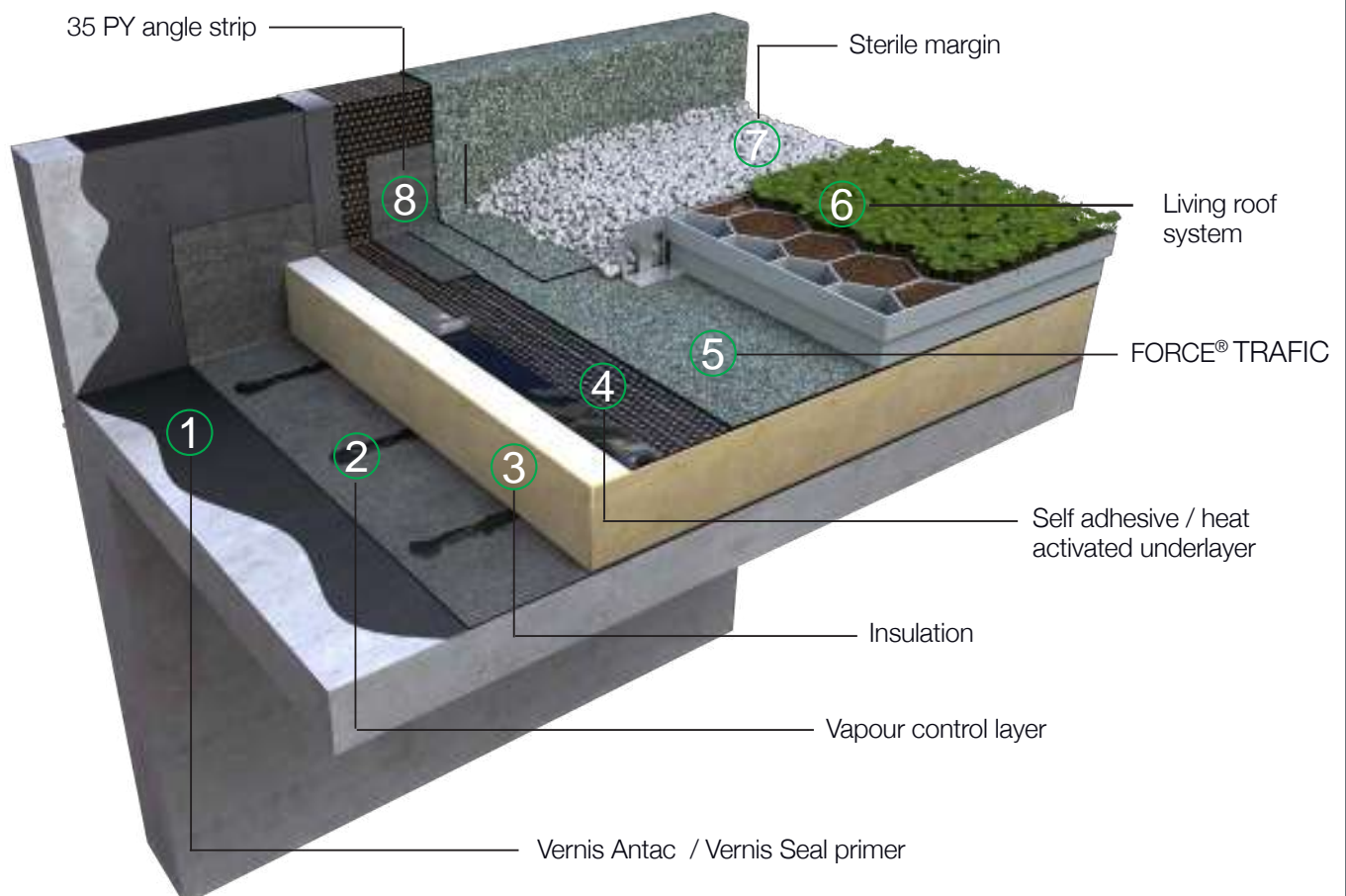

ECOFLEX®

Single-Ply PVC-p synthetic waterproofing

Lightweight, strong, flexible

Single-Ply PVC-p waterproofing, engineered for durability and flexibility. With improved environmental credentials and lightweight yet strong performance characteristics, ECOFLEX® is manufactured for widespread use on all roofing projects including domestic, commercial and industrial structures.

Key Advantages

- Proven, reliable solution for flat roofing
- Mechanically fixed (Ecoflex FM) and adhered (Ecoflex ADH) options available
- Fast application
- Flame free application - hot air welded seams eliminates the need for a hot works permit
- Versatile - designed for widespread use
- BBA approved
- 30 year manufacturer service life
- 20 year guarantee covering workmanship, materials and design



ECOFLEX® Warm Roof Build Up Mechanically Fixed

(fully adhered (ADH) fleece backed option also available)

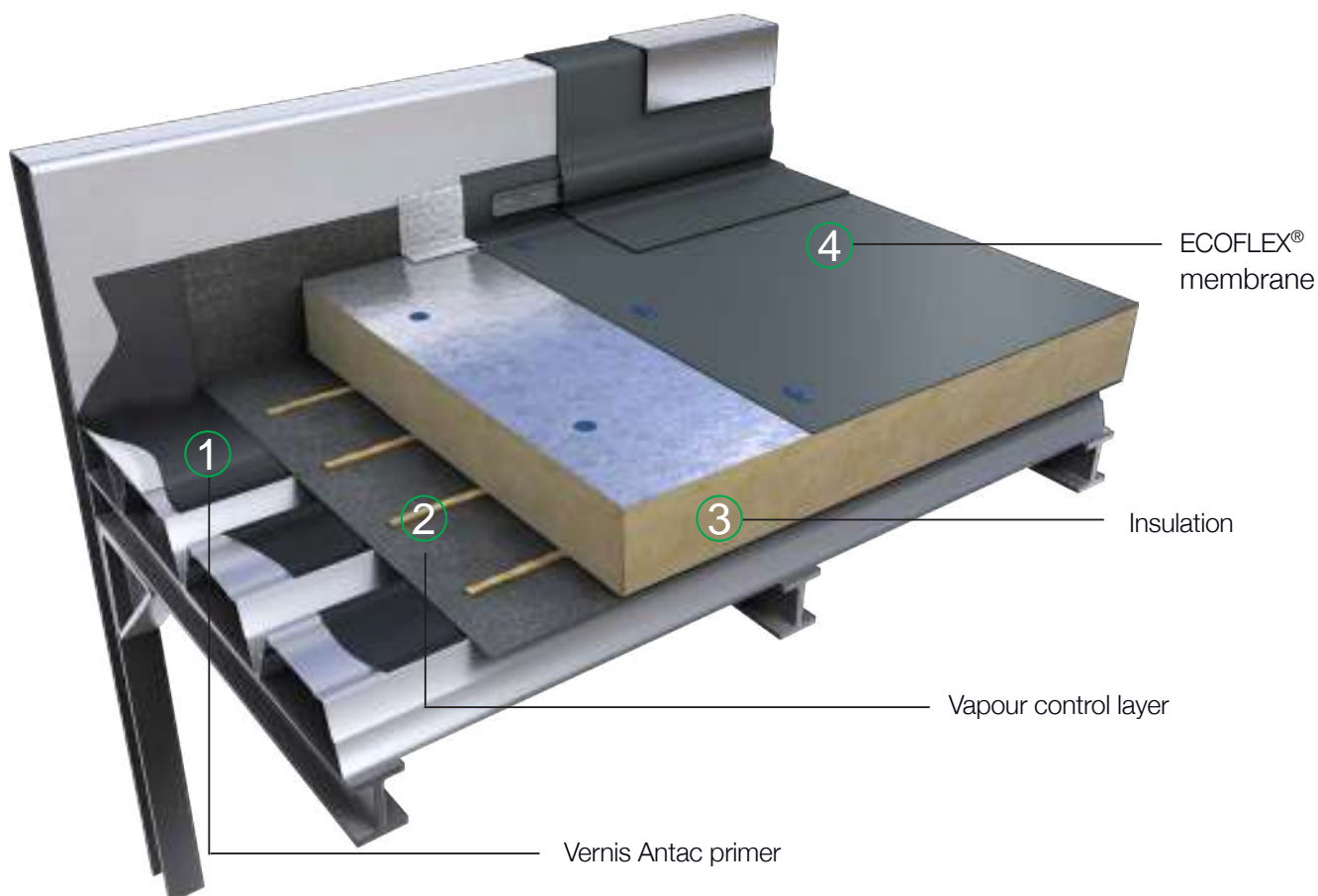



STARCOAT® QC

Single component cold applied liquid polyurethane waterproofing

Superior material flexibility

Quick curing single component synthetic cold applied liquid waterproofing system, for use on new construction and refurbishment projects. Developed to help make a variety of complex roofs and penetration details simple to waterproof in a seamless, flexible, cost-effective and heat-free application. Ideal for use as a standalone remedial or primary waterproofing system on refurbishment projects.



Key Advantages

- Single component system
- Tough, elastomeric membrane capable of withstanding structural and thermal movement
- Quick curing time of 4-8 hours
- Rain proof after 3-4 hours at ambient temp of 20 °C
- Range of colors and wearing courses available
- No termination and mechanical fixing
- ETA and BBA accreditation
- 25 year manufacturer service life
- 20 year guarantee covering workmanship, materials and design

STARCOAT® PMMA

Cold applied polymethyl methacrylate-based liquid waterproofing

Seamless and highly flexible

A rapid curing, seamless liquid waterproofing system able to withstand mechanical stresses and is ideal for crack-bridging, joint-bridging and suitable for almost all substrates. It can be used as a standalone remedial or primary waterproofing system for cold, inverted and warm roof design. Comprising two components including a peroxide catalyst to accelerate the curing process, STARCOAT® PMMA boasts quick and simple application, allowing small and difficult to access roof spaces to be waterproofed, as well as enabling complex roof penetrations to be reliably and durably incorporated.



Key Advantages

- Two component system - liquid & catalyst
- Fully bonded to the substrate
- Can be applied to almost any substrate
- Standard curing time 15 – 18 min at 20 °C
- Rain proof within 15 - 18 min at 20 °C
- Approved for application down to a zero fall
- Variety of finishes available
- Solvent free, flame free and root resistance
- No termination and mechanical fixing
- BBA / ETA accredited
- 25 year manufacturer service life
- 20 year guarantee covering workmanship, materials and design



LIVING ROOF

Increases biodiversity, giving new space for habitats to form

Lightweight, strong, flexible

Axter's living roof systems are engineered to accommodate the most varied ecological and environmental requirements. The combination of horticultural expertise with long term system performance ensures total compliance with all local, national and project specific environmental, biodiversity and attenuation criteria.

Key Advantages

- Increases biodiversity, creating habitat for birds, bees and invertebrates
- Aesthetically pleasing, with a wide variety of plant options
- Provides good sound insulation from rain
- Reduces rainwater run off flow rates
- Reduces the urban heat island effect
- Improved thermal performance

HYDROSOIL

A traditional built-up green roof system comprising of a water retention / drainage board layer, integral filter layer, growing medium and planting to suit the biodiversity requirements - providing a habitat for invertebrates, butterflies, moths and birds. A variety of engineered soil mixtures, plant types and planting options are available to suit the project requirements.

HYDROLITE

A lightweight, extensive green roof finish, that utilises specialist hydroponic technology to provide a high quality mineral substrate, that is ideal for buildings where loading is at a premium, especially industrial units.

HYDROBROWN

A bio-diverse brown roof designed to replicate the bio-diversity of the original brownfield site. Comprising a drainage layer with integral filter and a growing medium of a varied depth laid bare and left to 'self-seed' (this can include recycled and screened site spoil). To reduce weight loads, installation time and costs, a brown roof growing medium manufactured off-site can be provided. Additional planting options (Hydroseed seed mixes) and micro-habitats can also be supplied to provide greater bio-diversity.

HYDROSEED

A specific seed mix that has been developed by horticultural specialists to be sown on the Hydrobrown substrate for the creation of bio-diverse roofs. The seed mix contains at least 30 different plant species, predominantly herbaceous, and engineered to provide colour throughout the year.



SOLAR PV

Fully integrated solar photovoltaic membranes

Flexible, high energy output PV

General Solar PV is a high performance waterproofing system that utilises thin film UNI-SOLAR technology to harvest power from the sun. The solar cell modules are fully integrated with the reinforced bituminous membranes providing high quality waterproofing as well as the production of clean electrical energy in the same product. Retro-fit options are also available for just the Solar PV using BANDFIX Velcro technology - further details available upon request.

Key Advantages

- Proven reliable and renewable energy source
- Shatter proof and resistant to hail
- Produces between 7 and 22% more energy than crystalline panels
- Solar cells made up of thin film triple junction amorphous silicon
- Continues to produce energy even if a cell is damaged due to serially connected diodes
- MCS Certified
- 25 year warranty on power output at 80%

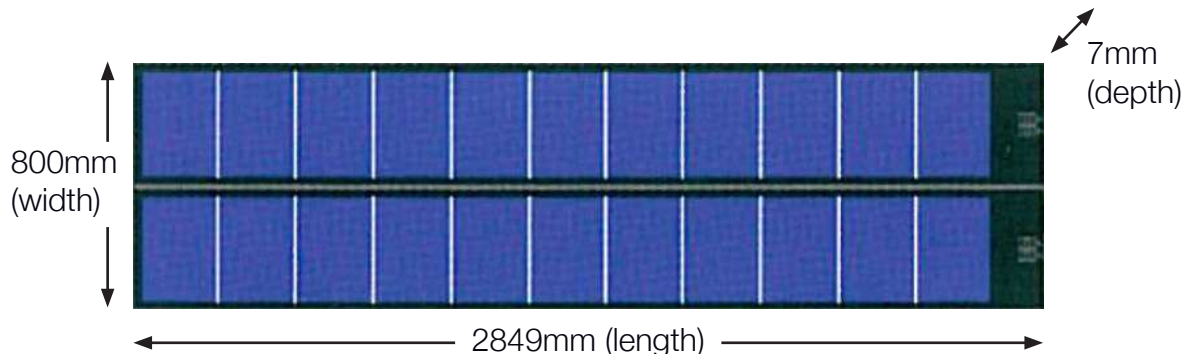

How it works

Axter General Solar PV incorporates UNI-SOLAR thin film with triple section amorphous silicon solar cells into the surface of the waterproof cap sheet. The blue, green and red component of the solar light spectrum is absorbed in a refracted way by the three different layers, and even in low levels or indirect sunlight the highest productivity of energy is obtained compared to traditional poly or mono crystalline panels.

Solar Cells

Each module measures 2849 x 800 x 7mm (area 2.28sqm) and weighs only 7.9kg (3.5kg / sqm), and will provide an average output of 136 Wp. The cells are shatter-proof, hail resistant and very flexible, making them suitable for all roof shapes with no requirement for orientation, plinths or ventilation. General Solar PV is guaranteed to still be generating at a minimum of 80% of its full efficiency 25 years after installation.

Contact Axter for a project specific layout design using the General Solar thin Film PV Modules.



AXTER WORLDWIDE



UK - Ipswich | FRANCE - Paris, Illzach, Courchelettes | SPAIN - Barcelona | CANADA - Québec | BELGIUM - Hasselt | AUSTR



Waterproofing Systems.

**Proactive collaboration
through strong and
sustainable partnerships,
combined with excellence
in design, manufacture
and installation.**

Axter Ltd
West Road
Ransomes Europark
Ipswich IP3 9SX

01473 724056
www.axter.co.uk

