

1	ECOFLEX® ADH fleeceback single ply membrane fully bonded using ADH adhesive
2	ADH adhesive
3	Heat welded seam - 40mm
4	ECOMETAL® preformed PVC coated metal with mechanical (C) fixings at 200mm ctrs
5	ECO/R cover strip
6	Restraint bar and mechanical (C) fixing
7	HYTHERM® ADH tapered / flat board insulation fully bonded using Hyra-Stik
11	EVO adhesive (thickness to achieve design U-value and/or minimum 1:40 design fall)
8	ECOFLEX® air & vapour control layer (AVCL)
9	Vernis Antac ST Primer
10	Plywood roof deck by specialist contractor
11	Mechanically fixed hard edge by specialist subcontractor

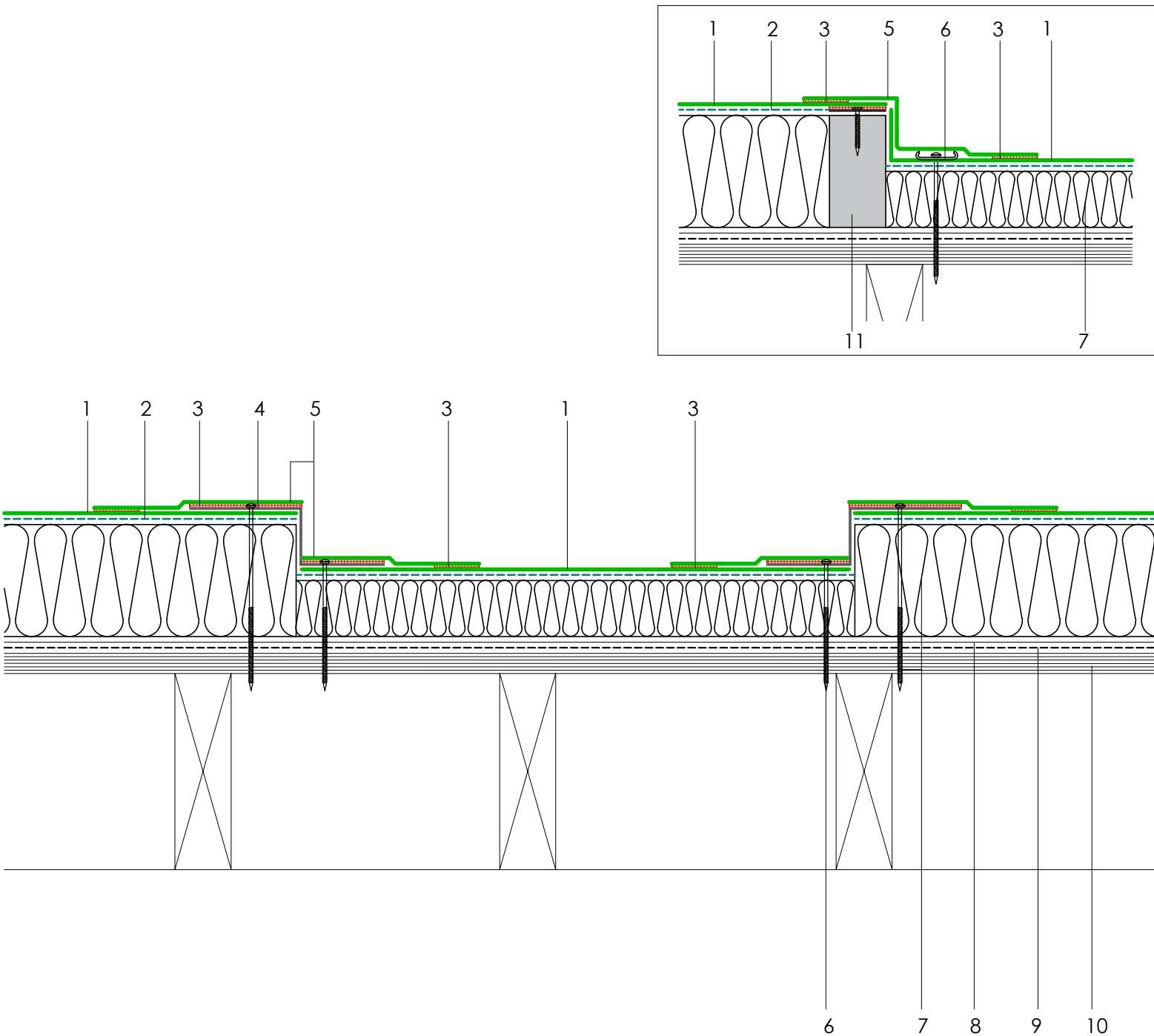

www.axterhd.co.uk  
 info@axterhd.co.uk  
 01473 724056

Axter Ltd.  
 West Road, Ransomes European,  
 Ipswich, Suffolk, IP3 9SX

Axter provide detail drawings as part of our technical design service. Such drawings should only be used as a guide during the design process and should not be utilised during construction. Axter accepts no liability for misuse of this service.

PROJECT : N/A

CLIENT : N/A

DRAWING : ECOFLEX® ADH TYPICAL INTERNAL GUTTER  
DETAIL

DWG.No

WR.P.EF.adh.190

SCALE

1:5 @ A4

DATE

2019

REV (if applicable)

N/A

STANDARD DETAIL

Ef

Ecoflex