



MEDITE[®] SMARTPLY[®]

Building The Future Plant List

Trees

Austrian Pine/European Black Pine
Pinus Nigra 'Austriaca'
Birch
Betula Pendula
Quaking Aspen
Populus Tremula
Scots Pine
Pinus Sylvestris
Serbian Spruce
Picea Omorika
Small Leaved Lime
Tilia Cordata 'Greenspire'

Shrubs

American Spikenard
Aralia Racemosa
Burning Bush/Winged Spindle
Euonymus Alatus Balls
Dogwood
Cornus Annys Winter Orange
Dwarf Cornel
Cornus Canadensis
Guelder Rose
Viburnum Opulus
Hawthorn
Crataeus Monogyna

Hazel
Corylus Avellana
Japanese Long Leaved Laurel
Aucuba Salicifolia Sub Crassifolius
Japanese Spikenard
Aralia Cordata
Oak Leaved Hydrangea
Hydrangea Quercifolia
Rambling Rose
Rosa Kiftsgate
Red Osier Dogwood
Cornus Stolonifera Flavirameae

Ricepaper Tree
Tetrapanax
Shrub Rose
Rosa Kew Gardens
Spindle
Euonymus Alatus
Spirea
Spiraea Nipponica Snowmound
Sweetshrub Venus
Calycanthus Venus
White Flowering Escallonia
Escallonia Iveyi

Plants

Angelica
Angelica Archangelica
Baby's Tears
Soleirolia Soleioli
Balm Leaves Red Dead Nettle
Lamium Orvala
Barrenwort
Epimedium Pinnatum Colchicum
Big Blue Lily Turf
Liriope Big Blue
Black Pea
Lathyrus Niger
Bleeding Heart (White)
Lamprocapnos Alba
Blue Corydalis
Corydalis Craighton Blue
Blue Corydalis
Corydalis Flexuosa
Borage
Borago Officinalis
Bowman's Root
Gillenia Trifoliata

Box Leaved Honeysuckle/Privet
Honeysuckle
Lonicera Pileata Moss Green
Bulley's Primrose
Primula Bulleyana
California Greyrush
Juncus Carmans Gray
Canadian Wild Ginger
Asarum Canadense
Cast Iron Plant
Aspedistra Elatior
Catnip
Nepeta Cataria
Chinese Rhubarb
Rheum Palmatum
Chinese Wild Ginger
Asarum Splendens
Columbine/Granny's Bonnet
Aquilegia Vulgaris Nivea
Comfrey
Symphytum Hidcote Blue
Common Ivy
Hedera Helix

Common Polypody
Polypodium Vulgare
Common Reed
Phragmites Australis
Copper Shield Fern
Dryopteris Erythrosora
Corsican Mint
Mentha Requenii
Corydalis
Corydalis Korn's Purple
Cow Parsley
Anthriscus Ravenswing
Cranesbill
Geranium Nodosum Clos Du Caudray
Creeping Savory
Satujera Spicigera
Creeping Saxifrage
Saxifraga Stolonifera
Curly Wood Sage
Teucrium Scorodonia 'Crispum'
Deer Fern/Hard Fern
Blechnum Spicant
Diamond Leaf Fern
Lophosora

Double Meadow Buttercup
Ranunculus Acris Flore Pleno (Multiplex)
Dusky Cranesbill
Geranium Phaem
Dyers Woodruff
Asperula Tinctoria
Eastern Bluestar
Amsonia Ernest Pagels
Eastern Bluestar
Amsonia Tabaermontana
Elderberry Rodgersia
Rodgersia Sambucifolia
European Wild Ginger
Asarum Europaeum
Evergreen Maidenhair
Adiantum Vesustum
False Castor Oil Plant/Japanese
Aralia
Fatsia Japonica
Fringe Cups
Tellima Grandiflora
Fringe Flowered Campion
Silene Fimbriata

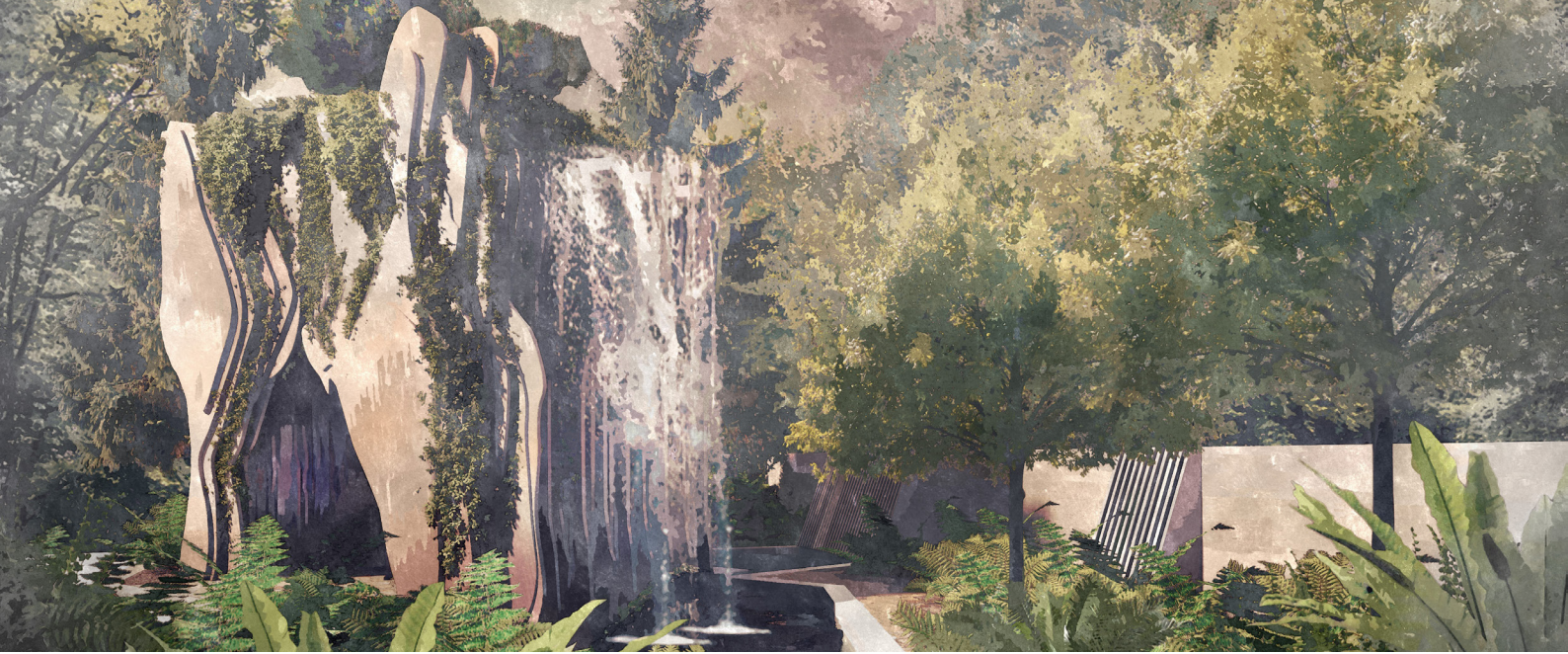

Giant Blue Hosta
Hosta Sieboldiana Elegans

Giant Cowslip
Primula Florindae

Globe Flower
Trollius Lemon Queen

Globeflower
Trollius Dancing Flame

Goat's Beard
Aruncus Doicus

Goat's Beard
Aruncus Horatio

Gotu Kola
Centella Asiatica

Hardy Umbrella Plant
Schefflera Taiwanniana

Harts Tongue Fern
Asplenium Scolopendrium

Honey Bush
Melianthus Major

Italian Arum
Arum Italicum

Ivy Leaved Toadflax
Cymbalaria

Jacobs Ladder
Polemonium Bressingham Purple

Jacobs Ladder
Polemonium Lambrook Mauve

Japanese Bugbane
Actaea Japonica

Japanese Bugbane
Actaea Matsumurae White Pearl

Japanese Spurge
Pachysandra Green Carpet

Kraus's Clubmoss
Selaginella Kraussiana

Labrador Violet
Viola Labrodorica

Lancewood
Pseudopanax Moas Toes

Lemon Scented Catnip
Nepeta Cataria 'Citriodora'

Leopard Plant
Farfugium Wavy Gravy

Maidenhair Spleenwort
Asplenium Trichomanes

Marsh Spurge
Euphorbia Palustris

Martin's Spurge
Euphorbia Martinii

Mayapple/Wild Mandrake
Podophyllum Peltatum

Mayapple/Wild Mandrake
Podophyllum Spotty Dotty

Meadow Buttercup
Ranunculus Acris

Meadowsweet
Filipendula Ulmaria

Meadowsweet
Filipendula Vulgaris

Merrybells
Uvularia

Meu
Meum Athamanticum

Mexican Fleabane
Erigeron Karvinskianus

Moss
Bryophyta

Nest Moor Grass
Sesleria Nitida

Oak Fern
Gymnocarpium Dryopteris

Oregon Grape
Mahonia Soft Caress

Ostrich Fern
Matteuccia Struthiopteris

Parsnip
Pastinaca Satvia

Peltaboykonion
Peltaboykonion Watanabei

Plantain Leaf Sedge
Carex Plantaginacea

Purple Moor Grass
Molinia Caerulea

Purple Moor Grass
Molinia Moorhexe

Red Valerian
Centranthus Ruber

Remote Sedge
Carex Remota

Rhubarb
Rheum Ace Of Heart

Rigid Holly Fern
Polystichum Rigens

Rodger's Bronze Leaf
Rodgersia Podophylla

Rough Horsetail
Equisetum Hyemale

Salad Burnet
Sanguisorba Minor

Scaly Male Fern
Dryopteris Affinis

Scotch Lovage
Ligusticum Scoticum

Shield Leaf Rogers Plant
Astilboides Tabularis

Siberian Bugloss
Brunnera Sibirica

Siberian Iris
Iris Sibirica Blue King

Siberian Iris
Iris Sibirica Gullswing

Siberian Iris
Iris Sibirica Papillon

Siberian Melic
Melica Altissima Alba

Snowy Wood Rush
Luzula Nivea

Solomon's Seal
Polygonatum

Sulphur Clover
Trifolium Ochroleucon

Sweet Box
Sarcococca Confusa (Ruscifolia)

Sweet Cicely
Myrrhis Odorata

Sweet Woodruff
Galium Odoratum

Sword Fern
Polystichum Munitum

Townhall Clock
Adoxa Moschatellina

Tree Ivy
Hedera Arborea/Fatshedera

Turks Cap Lily
Lilium Martagon Guinea Gold

Umbrella Plant
Darmera Peltata

Virginian Skullcap
Scutellaria Lateriflora

Water Avens
Geum Rivale

Wherrys Foam Flower
Tiarella Wherryi

White Flowered Foxglove
Digitalis Albiflora

White Harts Pennyroyal
Mentha Cervina Alba

Wild Garlic
Allium Ursinum

Wild Rhubarb
Gunnera Perperna

Woad
Isatis Tinctoria

Yellow Wax Bells
Kirengoshima Palmata